



Penmanor | Finstall | Bromsgrove | Worcestershire **Offers in Excess of £200,000**

Penmanor

Finstall | Bromsgrove

A THREE BEDROOM ATTACHED COTTAGE

An utterly charming, THREE BEDROOM attached cottage. Occupying a most sought after location and pretty setting, in Finstall Village. Popular for its schooling, proximity to shops and railway station in Aston Fields, as well as bus and road links to both Bromsgrove and Redditch. The property is set back behind a wide fore garden, having parking to front for one car and an enclosed sun trap seating area. Access to secure storage shed sits adjacent to the front door. The internal layout comprises: Initial hall, well -proportioned lounge with feature fireplace. Inner hallway, having walk-in pantry and access to the following rooms. Bedroom two, being dual aspect. Fitted kitchen to front, with tiles to walls, small hob and circular sink to work tops. Refitted shower room featuring a sink and w.c. inset to units, and a generous shower enclosure. Further bedroom three and the master bedroom, this being dual aspect and with the advantage of a built-in shower to the corner. The property has combination gas fired central heating and double glazing. VIEWING IS HIGHLY RECOMMENDED FOR THIS MOST UNIQUE HOME.



Details

Entrance Hall

Lounge

14' 5" x 12' 6" (4.39m x 3.81m)

Inner Hallway

Bedroom 2

11' 2" x 8' 8" (3.40m x 2.64m)

Kitchen

9' 0" x 6' 9" (2.74m x 2.06m)

Shower Room

9' 4" x 5' 2" (2.84m x 1.57m)

Bedroom 3

8' 11" x 8' 7" (2.72m x 2.61m)

Master Bedroom

15' 2" x 12' 8" (4.62m x 3.86m)



Tenure: We have been advised by our vendor that the property is **Freehold** (tbc by solicitors).

Council Tax Band: (tbc by solicitors).

Please Note: These plans are for information only and not to scale.

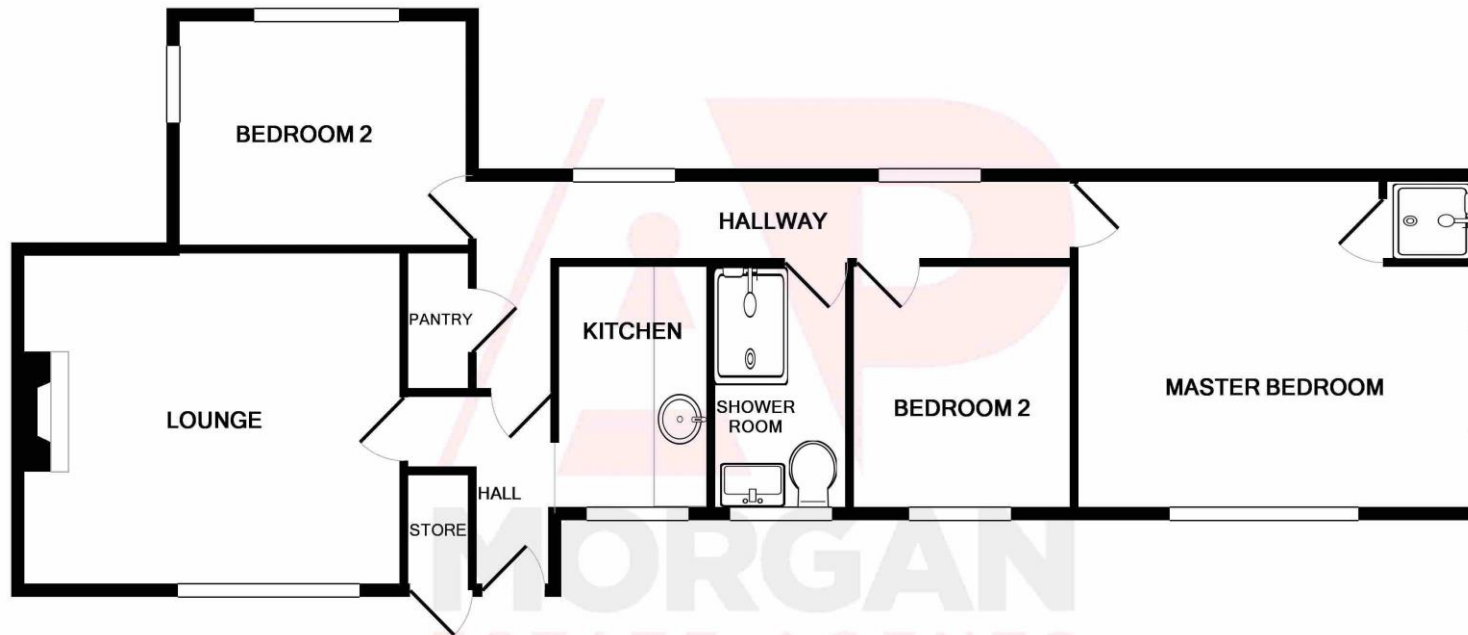

TOTAL APPROX. FLOOR AREA 788 SQ.FT. (73.2 SQ.M.)

Whilst every attempt has been made to ensure the accuracy of the floor plan contained here, measurements of doors, windows, rooms and any other items are approximate and no responsibility is taken for any error, omission, or mis-statement. This plan is for illustrative purposes only and should be used as such by any prospective purchaser. The services, systems and appliances shown have not been tested and no guarantee as to their operability or efficiency can be given

Made with Metropix ©2019

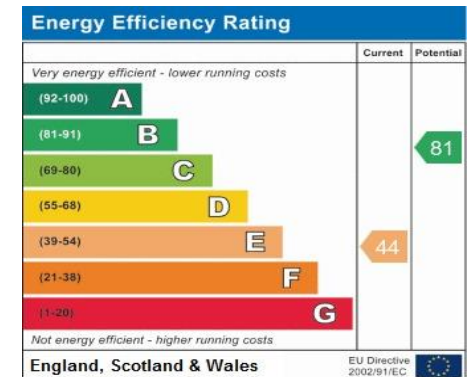

Office Opening Times: Monday – Friday (9am – 5:30pm) | Saturday (9am – 4pm) | Sunday (Closed)

No statement in these details is to be relied upon as representation of fact, and purchasers should satisfy themselves by inspection or otherwise as to the accuracy of the statements contained within. These details do not constitute any part of any offer or contract. **AP Morgan** and their employees and agents do not have any authority to give any warranty or representation whatsoever in respect of this property. These details and all statements herein are provided without any responsibility on the part of **AP Morgan** or the vendors. **Equipment:** **AP Morgan** has not tested the equipment or central heating system mentioned in these particulars and the purchasers are advised to satisfy themselves as to the working order and condition. **Measurements:** Great care is taken when measuring, but measurements should not be relied upon for ordering carpets, equipment, etc. The Laws of copyright protect this material. **AP Morgan** is the Owner of the copyright. This property sheet forms part of our database, and is protected by the database right and copyright laws. No unauthorised copying or distribution without permission.