



**Hampton Loade Park Homes, Bridgnorth**  
**Guide Price £145,000**

**Features:**

- Rural Location
- 2 Bed Detached Park Home
- Lounge & Dining Area
- Spacious Kitchen
- Master Bedroom & En-suite
- House Bathroom
- Garden & Off Road Parking
- Central Heated Property

**Description:**

AP Morgan are pleased to offer this 20x40 Small and select development in spectacular riverside location not far from the village of Alveley and Bridgnorth. The area is well known for its fishing, avid walkers, national trust, pubs and canoeing. Located at the end of this select small development, this immaculately presented 2 Double Bedroom Park home. The Layout in brief comprises: Entrance Hall, a spacious and well appointed Lounge/Dining Room with feature fireplace, Excellent Fitted Breakfast Kitchen with built in cooker and appliances, Master Bedroom with fitted walk-in wardrobe and En-Suite Shower Room, a second well sized Double Bedroom with fitted wardrobes, a House Bathroom with W.C. Externally the property offers Parking space for two vehicles., a well sized rear Garden with stunning views over the woodland and pleasant seating area. Viewing is highly advised to appreciate property, and location. Available for residents aged 45 years and over.



**Details:**

**EPC Rating:** N/A

**Council Tax Band:** A (tbc by solicitors).

**Tenure:** Leasehold (tbc by solicitors).

For more information or to arrange a viewing, please call us on 01384 319 400.



## How can we help you?

### Need a mortgage?

We recommend Morgan Financial Solutions. They will search the market for you to ensure you get the right lender and mortgage deal. They typically achieve mortgage offers much more quickly than if you were dealing with lenders directly. The initial appointment is free and without obligation. Call us on 01384 319 400, or visit their website for more information: [www.morganfs.co.uk](http://www.morganfs.co.uk)

### Property to sell?

If you need to sell a property in order to buy, you ideally need to be on the market at least (and preferably Sold STC) before viewing, otherwise you may lose out to other buyers when the right property comes along. In these circumstances we can get your property 'live' quickly. Just book a free valuation and we will visit your property and discuss your needs.

### Need a solicitor?

A good solicitor can save you literally weeks of time in the buying/selling process, reducing the stress levels of all involved. We will instruct a reputable firm that is competitive on cost and very reliable. Just ask for a quote.

### Need a removal company and storage?

A professional removal company takes the stress out of moving. Knowing that your belongings are safe and insured far outweighs any small savings by trying to do it yourself or using a man-and-a-van service. We work closely with and recommend Cube Removals as the leading local firm. For peace of mind and a reliable service call them on 0800 193 0000 or visit their website, [cuberemovals.co.uk](http://cuberemovals.co.uk), to arrange a survey.

**Ground Floor**  
Approx. 71.5 sq. metres (770.0 sq. feet)

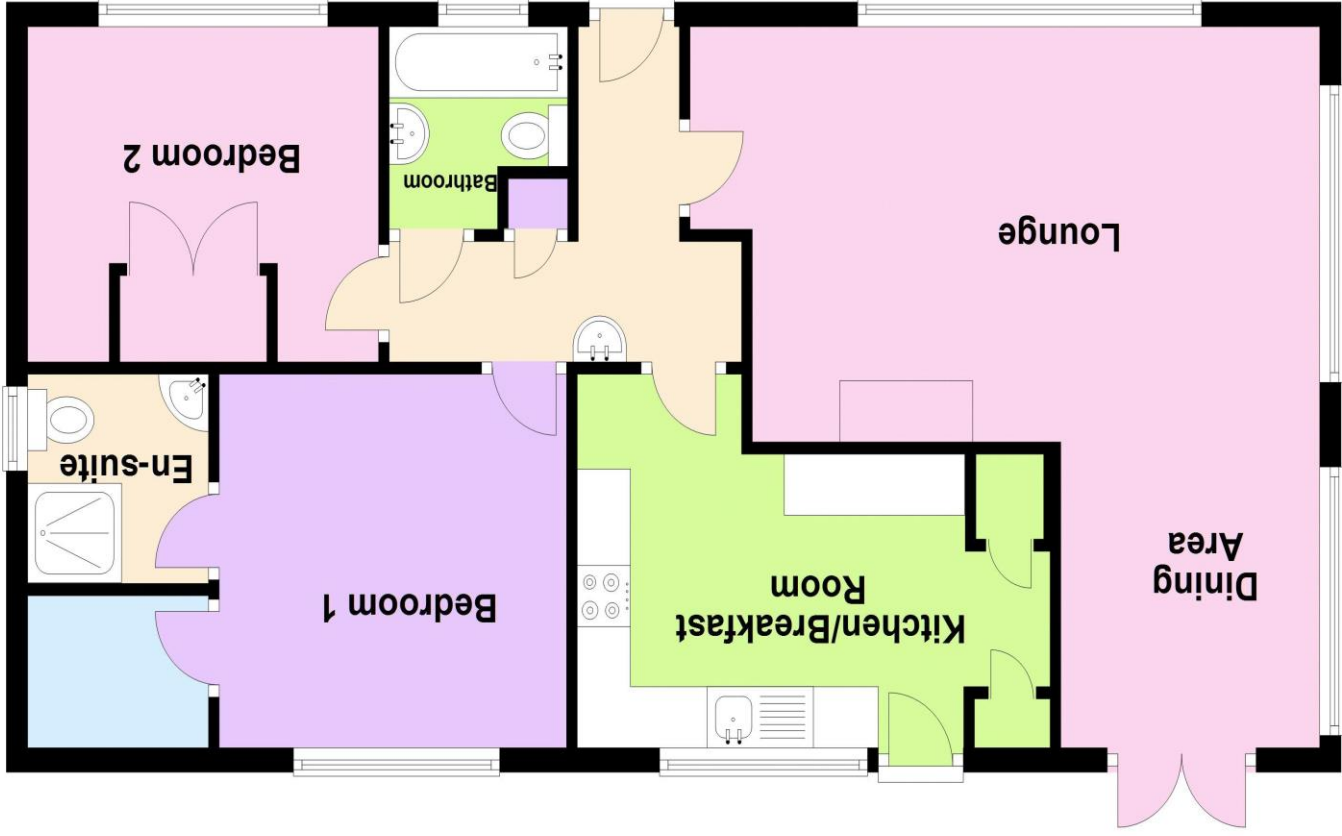

Total area: approx. 71.5 sq. metres (770.0 sq. feet)

No statement in these details is to be relied upon as representation of fact, and purchasers should satisfy themselves by inspection or otherwise as to the accuracy of the statements contained within. These details do not constitute any part of any offer or contract. AP Morgan and their employees and agents do not have any authority to give any warranty or representation whatsoever in respect of this property. These details and all statements herein are provided without any responsibility on the part of AP Morgan or the vendors. Equipment: AP Morgan has not tested the equipment or central heating system mentioned in these particulars and the purchasers are advised to satisfy themselves as to the working order and condition. Measurements: Great care is taken when measuring, but measurements should not be relied upon for ordering carpets, equipment, etc. The Laws of Copyright protect this material. AP Morgan is the Owner of the copyright. This property sheet forms part of our database and is protected by the database right and copyright laws. No unauthorised copying or distribution without permission.