



Plot 22, The Mallards,

Oldbridge Way

Bilsthorpe



£255,995

Chadwells
Estate & Letting Agents





Welcome

This remarkable four bedroom detached family home sits proudly within the Exclusive Peveril Homes Development within the heart of Bilsthorpe. Internally the ground floor consists of a large kitchen/diner, lounge, utility room with WC off. The first floor comprises of four sizeable bedrooms with the master benefiting from an en suite as well as a stylish family bathroom. Contact our office today for more information!

Ground Floor

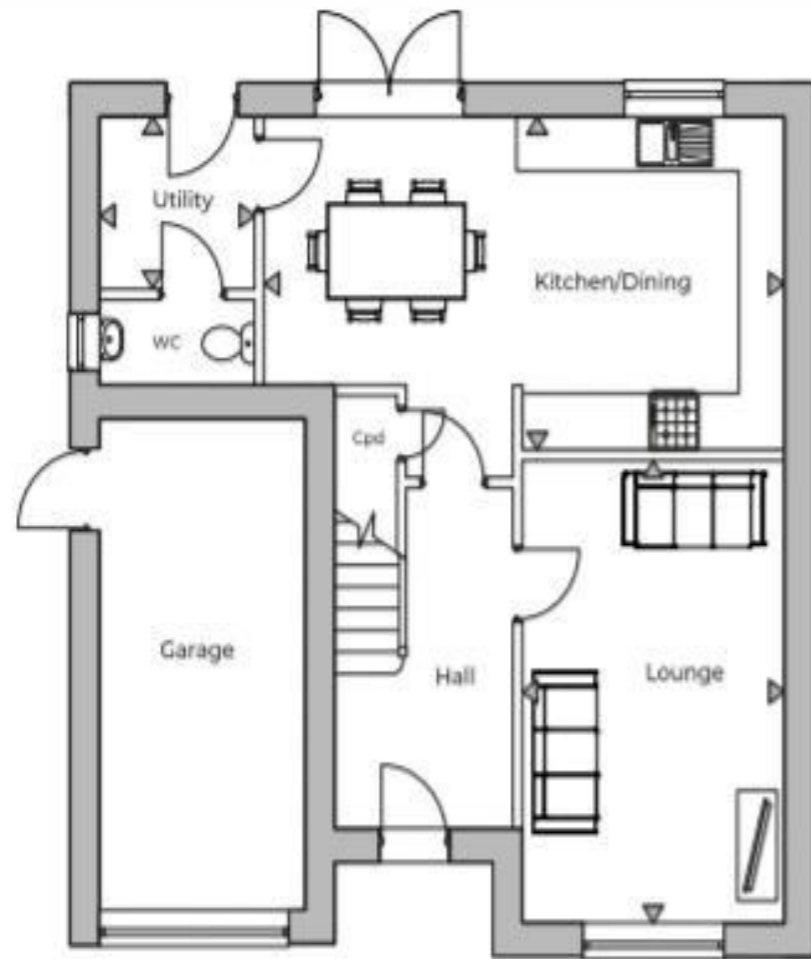

First Floor

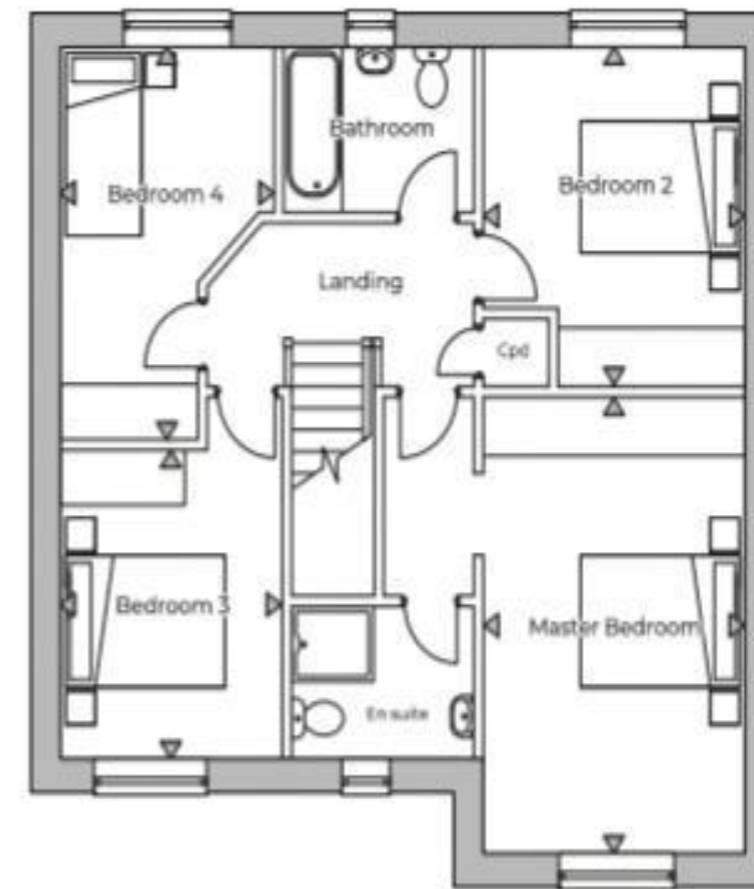

| Room | Measurements (metres) | Measurements (feet) | Plots |
|------------------|-----------------------|---------------------|--------|
| Kitchen / Dining | 6.34m x 3.52m | 20'9" x 11'6" | 20, 22 |
| Lounge | 3.17m x 4.88m | 10'4" x 16'0" | |
| Master Bedroom | 3.17m x 4.82m | 10'4" x 15'9" | |
| Bedroom 2 | 3.17m x 3.59m | 10'4" x 11'9" | |
| Bedroom 3 | 2.66m x 3.26m | 8'8" x 10'8" | |
| Bedroom 4 | 2.55m x 4.15m | 8'4" x 13'7" | |

Selling Homes with Bespoke Lifestyle Photography

Chadwells
Estate & Letting Agents

If you'd like to view this amazing
property, give us a call.

We'd Love To Show You Around!

Telephone: 01623 861 861

**Chadwells**
Estate & Letting Agents