



Harvard Court, Goodwill Road

Ollerton



Offers in Excess of £90,000

Chadwells
Estate & Letting Agents



(Chadwells



Chadwells

ARE YOU LOOKING TO GET ON
THE PROPERTY LADDER,
DOWNSIZE OR INVEST?



Chadwells



Chadwells



*Harward Court,
Goodwill Road*





Welcome

Offered for sale with no upward chain, this immaculately presented apartment is accompanied with allocated parking, open plan living space, family bathroom, en-suite and two well proportioned bedrooms. With good quality fixtures and fittings throughout this property is not expected to be around for long. Internal inspection is a must to appreciate the space and finish of this property, contact our office today to avoid missing out.



Step inside...

Entrance Hall

Accessed through wooden door from the communal entrance and having a large built in storage cupboard, radiator, pendant light fitting and carpet flooring.

Open Plan Living Space 18' 6" x 18' 1" (5.64m x 5.51m) at widest point

Fitted with a modern kitchen comprising of white wall and base units, square edge work surfaces inset with a stainless steel sink, drainer and mixer tap. Additional benefits include an integrated fridge freezer, eye level electric oven, gas hob with stainless steel extractor hood over, free standing washer dryer and space and plumbing for a dishwasher. Vinyl flooring to the kitchen space, carpet flooring to the dining and lounge area, uPVC windows to the rear and side aspect, two radiators, ceiling light fittings, BT point and TV point.

Master Bedroom 11' 1" x 12' 11" (3.39m x 3.93m) at widest point

French doors to the rear aspect with Juliet balcony, pendant light fitting, radiator and carpet flooring.

En-suite

Fitted with a modern three piece suite comprising off a shower tray with glass screen and electric shower, low flush WC and pedestal hand wash basin. Part tiled walls, radiator, extractor fan, ceiling light and vinyl flooring.

Bedroom Two 9' 11" x 10' 5" (3.01m x 3.17m)

With uPVC window to the rear aspect, radiator, pendant light fitting and carpet flooring.

Bathroom

Fitted with a modern three piece suite comprising of panel bath, pedestal wash basin and low flush WC. Tiled splash backs, extractor fan, radiator, ceiling light and vinyl flooring.

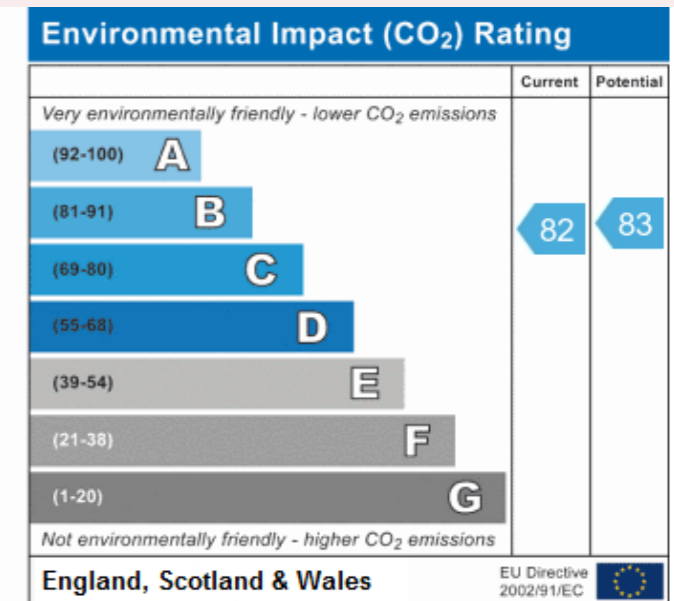
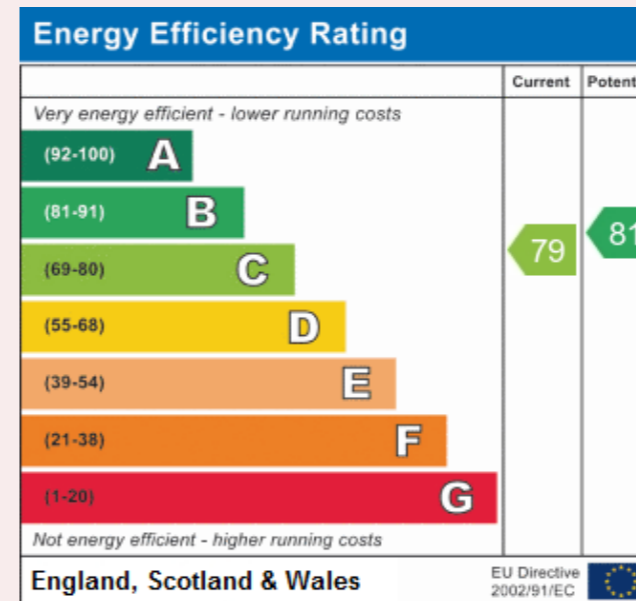

Address:
Harvard Court Goodwill Road

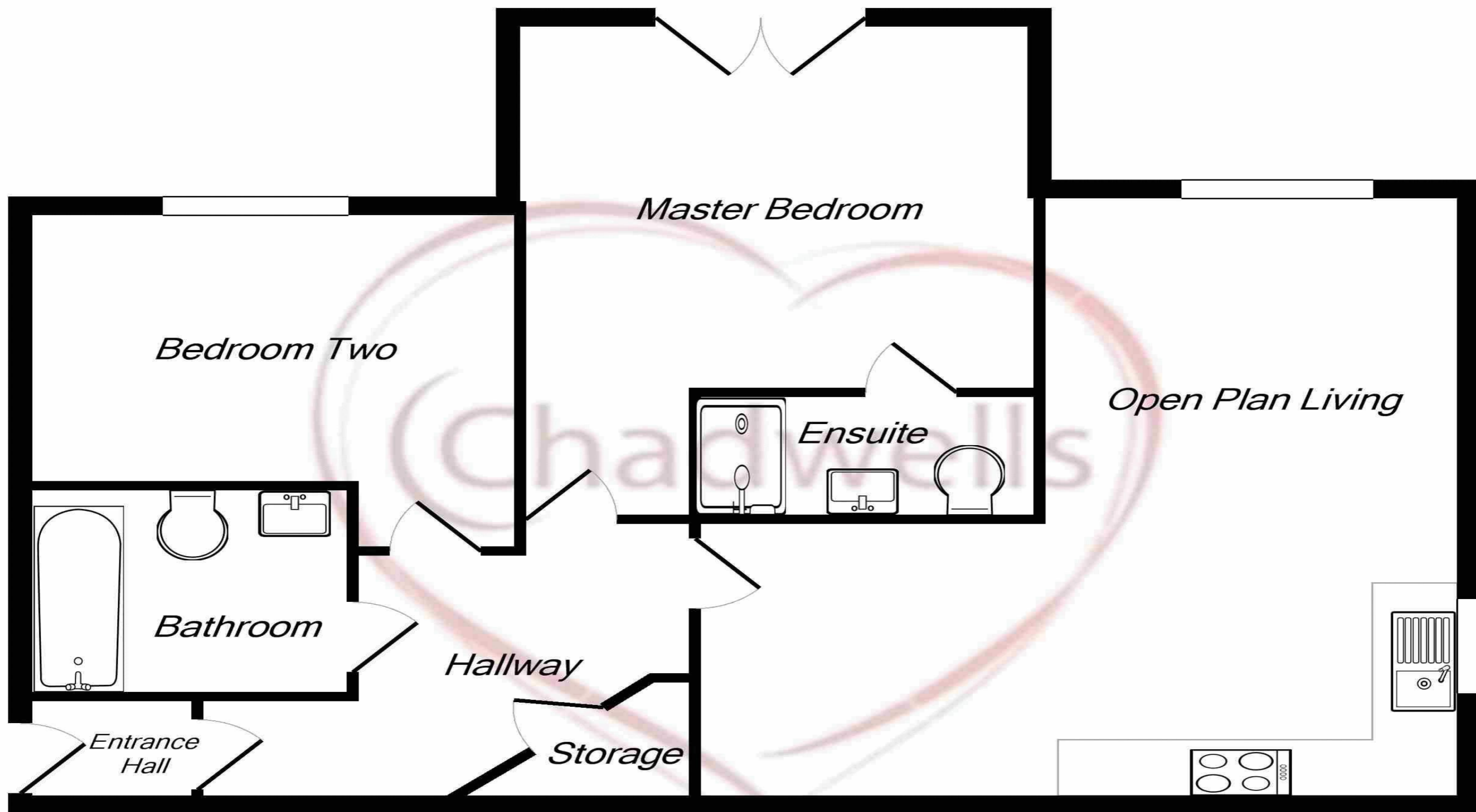

Total Approx. Floor Area 927 Sq.Ft. (86.1 Sq.M.)

Whilst every attempt has been made to ensure the accuracy of the floor plan contained here, measurements of doors, windows, rooms and any other items are approximate and no responsibility is taken for any error, omission, or mis-statement. This plan is for illustrative purposes only and should be used as such by any prospective purchaser. The services, systems and appliances shown have not been tested and no guarantee as to their operability or efficiency can be given

Made with Metropix ©2019



Chadwells

Selling Homes with Bespoke Lifestyle Photography

Chadwells
Estate & Letting Agents

If you'd like to view this amazing
property, give us a call.

We'd Love To Show You Around!

Telephone: 01623 861 861

**Chadwells**
Estate & Letting Agents