



exceptional service as standard.

01494 939868

hello@kingshills.co.uk

kingshills.co.uk



Hughenden Road | High Wycombe | HP13 5HS

Asking Price Of | £299,950

Property Description

Time for something special...

A brand new development that raises the bar for new build apartments in High Wycombe. Abbey Court is the latest development by prestigious local developer Barar Homes and offers what local buyers have been waiting for. Perfectly designed, spacious luxury apartments with parking and outdoor space, within walking distance of the train station and all of the town centre amenities. Kingshills are delighted to offer these apartments to the market. Please contact the team on 01494 939868 to book your viewing.

By far the most prestigious apartment of all at Abbey Court, this duplex apartment will defy your expectations. With accommodation spread cleverly over two floors, this property is a completely different sort of apartment. Perfect for those wanting space and luxury with the convenience of being in close proximity of the station and town. Large entrance hallway, leading to a double aspect kitchen/living/dining and bathroom. Full width stairs lead up to the first floor with two large, bright double bedrooms and a stylish shower room. Allocated Parking to the rear.

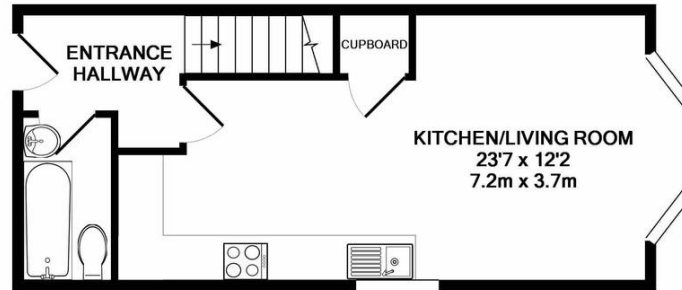

GROUND FLOOR

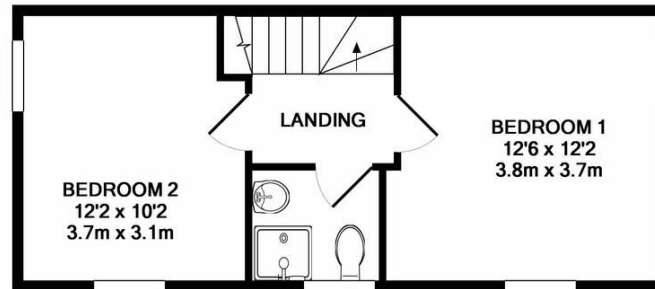

1ST FLOOR

TOTAL APPROX. FLOOR AREA 753 SQ.FT. (70.0 SQ.M.)

Whilst every attempt has been made to ensure the accuracy of the floor plan contained here, measurements of doors, windows, rooms and any other items are approximate and no responsibility is taken for any error, omission, or mis-statement. This plan is for illustrative purposes only and should be used as such by any prospective purchaser. The services, systems and appliances shown have not been tested and no guarantee as to their operability or efficiency can be given

Made with Metropix ©2019

Aston Court
Kingsmead Business Park
High Wycombe
Buckinghamshire
HP11 1JU

01494 939868
hello@kingshills.co.uk
kingshills.co.uk

Agents Note: Whilst every care has been taken to prepare these particulars, they are for guidance purposes only. All measurements are for general guidance purposes only and whilst every care has been taken to ensure accuracy, they should not be relied upon and potential buyers/tenants are advised to recheck the measurements